

SimplySleeper

Self-inflating

INSTRUCTION

PILLOW/MATTRESS INFLATION



1. Before inflation, make sure the deflation valve on the reverse side of the pillow is properly fasten.

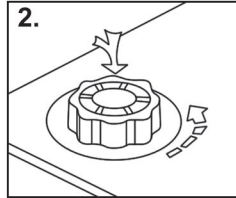

2. Loosen the self-inflating valve located on the mattress end. The mattress will automatically inflate itself.

The drawing shows the fully inflated mattress

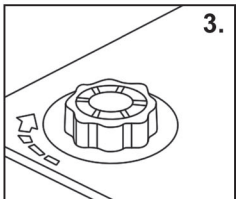
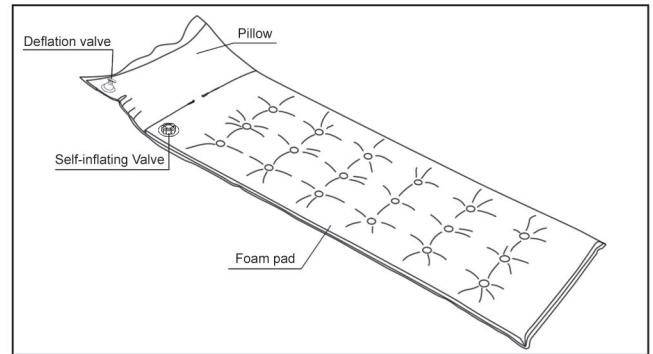

3. Fasten the self-inflating valve after the mattress is fully inflated.

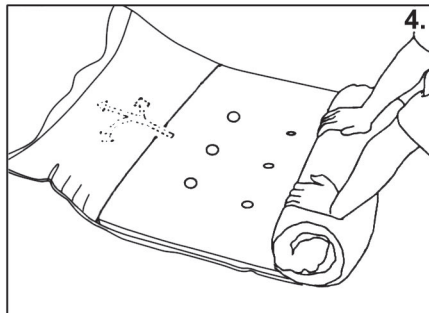

4. Roll up the mattress from the mattress end to push air from the mattress chamber into the pillow chamber through the built-in one-way valve. (Repeat steps 2-4 to reach the desired pillow firmness.)

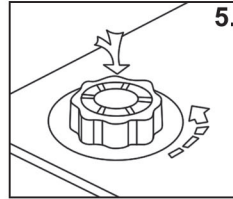

5. After the pillow is fully inflated, loosen the self-inflating valve to inflate the foam mattress for usage.

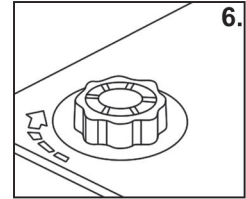

6. After the foam mattress is fully inflated, fasten the self-inflating valve and the mattress is ready for use.

PILLOW/MATTRESS DEFLATION

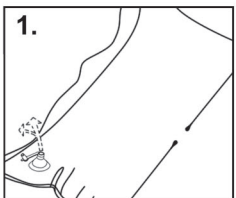

1. Unscrew the deflation valve on the pillow to deflate the pillow.

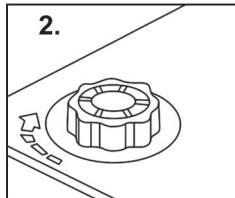

2. Fasten the self-inflating valve on the mattress.

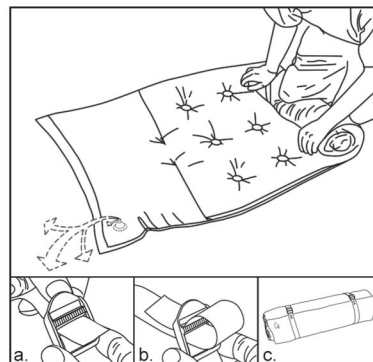

Roll up the mattress from the mattress end to push air out of the mattress, pillow area. Fasten the rolled-up mattress with two elastic straps for easy storage.

REPAIRING:(Repair Patch Included)

For small puncture holes, tear or cuts; Cut a small piece of PVC patch material (Included) and apply patch. Allow at least four (4) hours for repair to set before attempting to inflate the air bed.