

Simply Sleeper

Air bed with built-in rechargeable pump

This product may be covered under one or more of the following U.S. and / or foreign patents: U.S. Pat. Nos. : 2,425,162; 5,827,052; 6,004,116; 6,332,670 B1; 6,457,192; 6,581,223; 6,679,686 B2; 6,722,306 B1; 6,754,925 B1; 6,754,926 B2; 6,763,540; 6,793,469; 6,990,700 B2; 7,020,921 B2; 7,040,347 B2; 7,114,207; 7,120,955; 7,152,265; 7,246,394; 7,306,694; 7,313,837; 7,334,274; 7,346,950 B2; 7,365,277; 7,475,443; 7,597,123; 7,647,662; 7,739,760; 7,703,160; 7,739,763; GB2378987; GB2396670; CN 221,800; ZL01129383 Others
U.S. and International Patents Pending

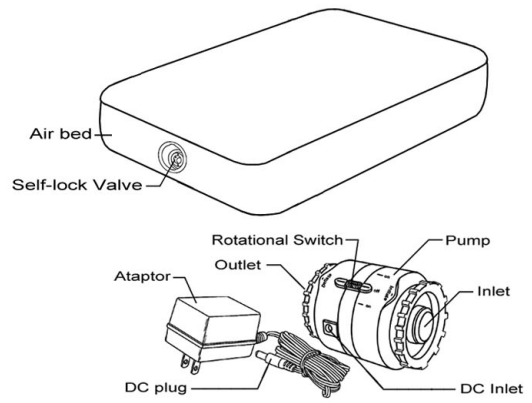

Pump must be charged for 12 hours prior to first use.

CARE AND MAINTENANCE:

For better protection of this product, never unfold or inflate the airbed in temperatures below freezing, avoid extensive exposure to the sun and protect from contact with sharp objects and rough ground. Clean air beds only with mild soap and water. Pump gasket may need occasional lubrication to maintain a positive seal.

NOTE:

Air bed material may stretch during first use and may need additional air to reach desired firmness. Air inside of bed may expand and contract with varying temperatures potentially leading to reduced pressure inside of bed.

REPAIRING:(Repair Patch Included)

For small puncture holes, tears or cuts, cut a small piece of PVC patch material (included) and apply patch. Allow at least four (4) hours for repair to set before attempting to inflate the air bed.

CAUTION:

1. Charge only with the transformer provided with the pump.
2. Plug into 120V AC electrical outlet for charge.
3. Do not charge the pump under temperature less than 41°F(5°C) or higher than 104°F(40°C)
4. Do not use under wet conditions.
5. Do not over inflate.
6. For proper pump usage, it is recommended not to exceed 10 minutes of inflation/deflation time, allow pump to cool off for 20 minutes.
7. Do not use as a water float or as a life saving device.
8. To keep the battery at optimum operating condition, always store pump with a full charge, recharge the pump every one month even if it has not been used.
9. Never allow sand, small rocks or any objects to be sucked into the pump while operating.
10. Do not try to disassemble, repair or service the pump or separate parts, once the pump is disassembled the warranty will be invalid.
11. The Maximum Weight Capacity for the queen size is 600 lbs, for the full size is 500 lbs and for the twin size is 400 lbs.

Inflation

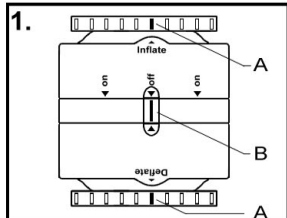

A: Switch Mark
B: Rotational Switch
Before inflation, make sure the pump rotational switch aligns with the "Off" arrow.

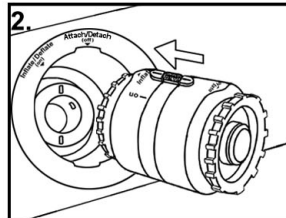

To attach pump for inflation, insert the pump by aligning the "Inflate" arrow sign on pump with the "Attach/Detach/Off" position on the air bed socket.

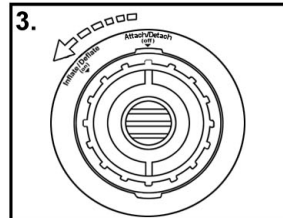

To inflate air mattress, turn pump counter-clockwise to align the switch mark on pump to the "Inflate/Deflate" position on the air bed socket.

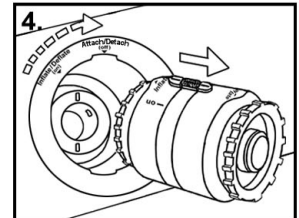

Upon reaching desired firmness, turn off pump by turning pump clockwise to align the switch mark on pump with the "Attach/Detach/Off" position on the air bed socket, your air bed is now air sealed and ready for use. Feel free to remove air pump to inflate alternative inflatable products.

Deflation

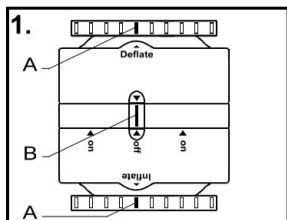

A: Switch Mark
B: Rotational Switch
Before deflation, make sure the pump rotational switch aligns with the "Off" arrow.

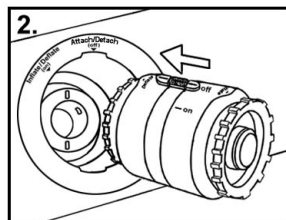

To attach pump for deflation, insert the pump by aligning the "Deflate" arrow sign on pump with the "Attach/Detach/Off" position on the air bed socket.

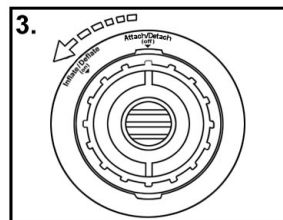

To deflate air mattress, turn pump counter-clockwise to align the switch mark on pump to the "Inflate/Deflate" position on the air bed socket.

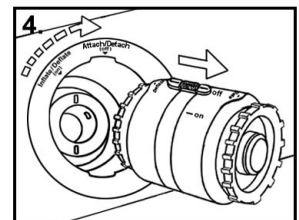

Upon deflation completion, turn off pump by turning pump clockwise to align the switch mark on pump with the "Attach /Detach/Off" position on the air bed socket, your air bed is now ready for storage. Feel free to remove air pump to inflate alternative inflatable products.

